

Lucas

Richland County Regional Planning Commission
 35 North Park Street, Suite 230,
 Mansfield, OH 4490
 phone: 419-774-568, fax: 419-774-5685

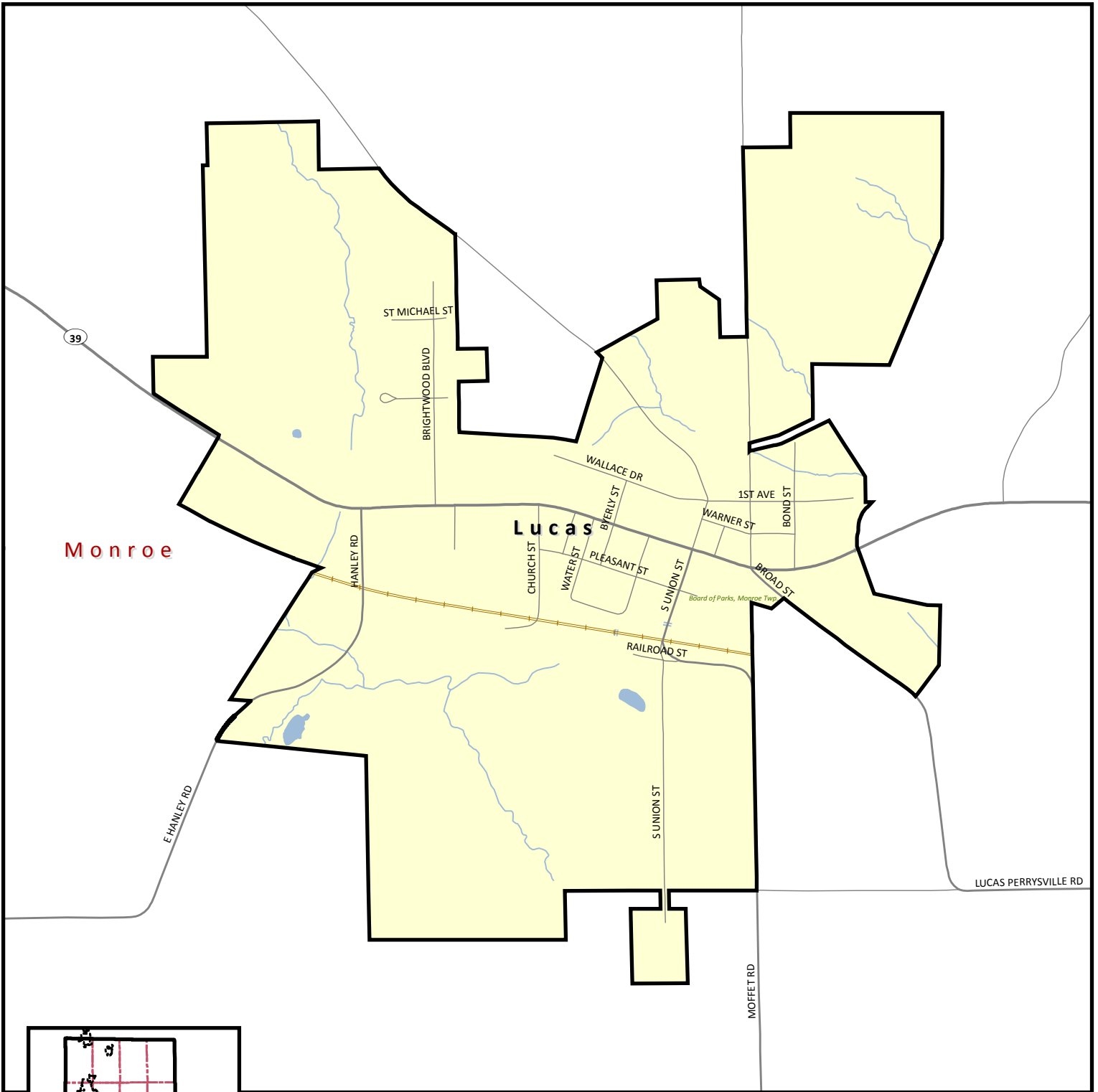

Monroe

Lucas

Board of Parks, Monroe Twp

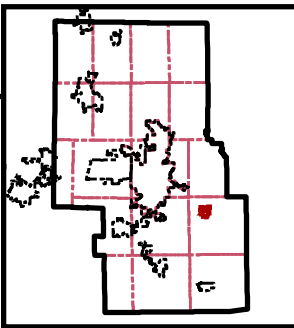

Legend

- Richland County Boundary
- Municipal Corporations
- Townships
- Rail
- Rivers
- Water
- Parks

Bellville

Richland County Regional Planning Commission
 35 North Park Street, Suite 230,
 Mansfield, OH 4490
 phone: 419-774-568, fax: 419-774-5685

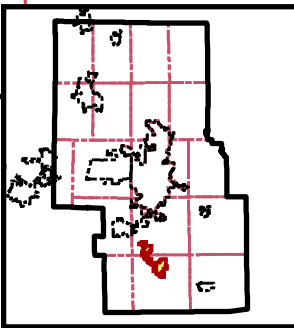
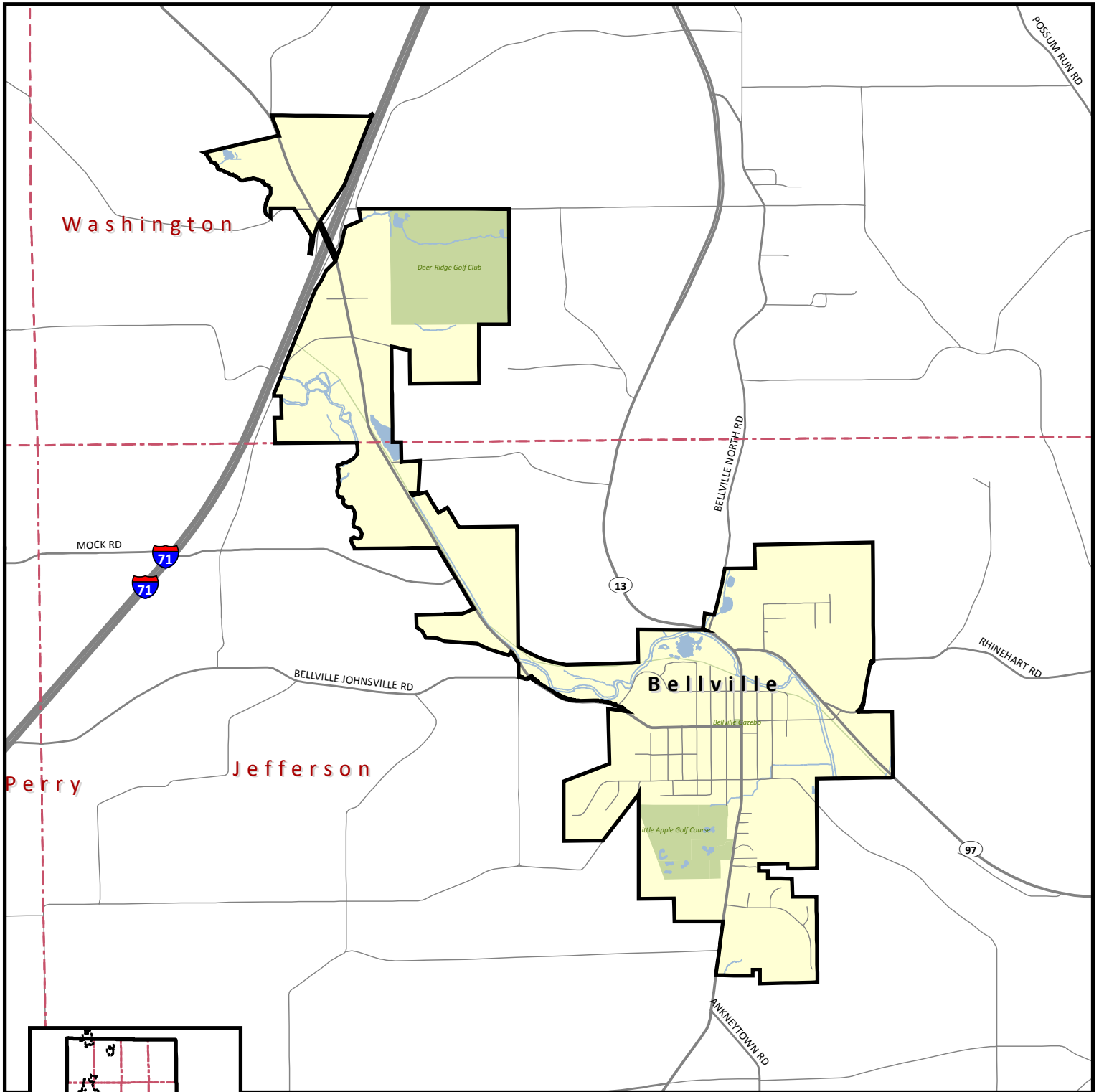

- Legend**
- Richland County Boundary
 - Municipal Corporations
 - Townships
 - Rail
 - Rivers
 - Water
 - Parks

Ontario

Richland County Regional Planning Commission
 35 North Park Street, Suite 230,
 Mansfield, OH 4490
 phone: 419-774-568, fax: 419-774-5685

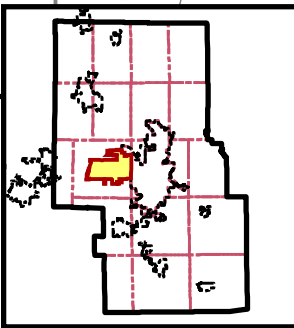
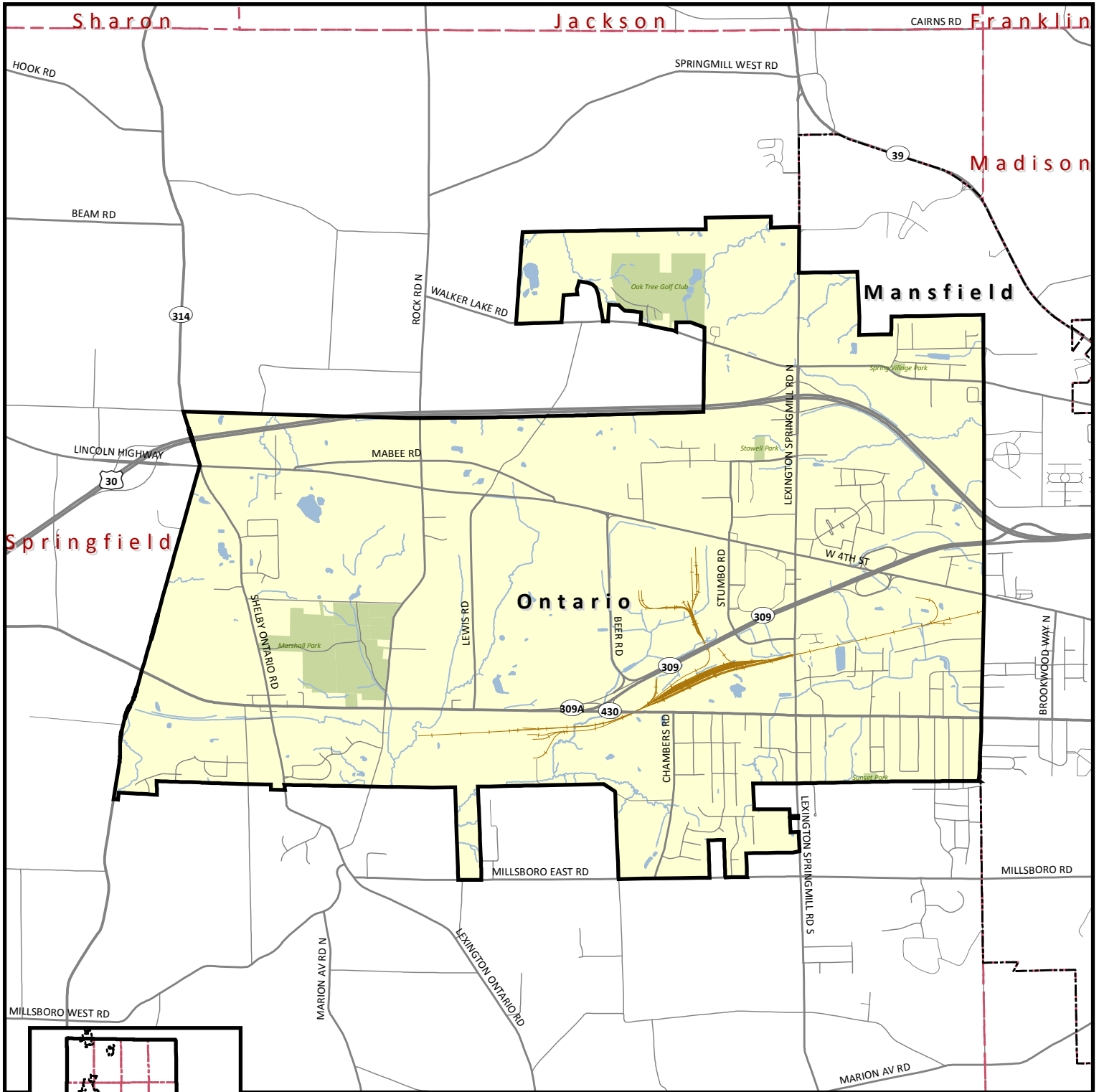

Legend

- Richland County Boundary
- Municipal Corporations
- Townships
- Rail
- Rivers
- Water
- Parks

Shiloh

Richland County Regional Planning Commission
 35 North Park Street, Suite 230,
 Mansfield, OH 4490
 phone: 419-774-568, fax: 419-774-5685

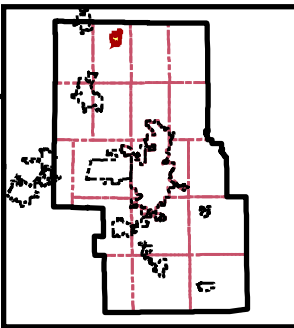
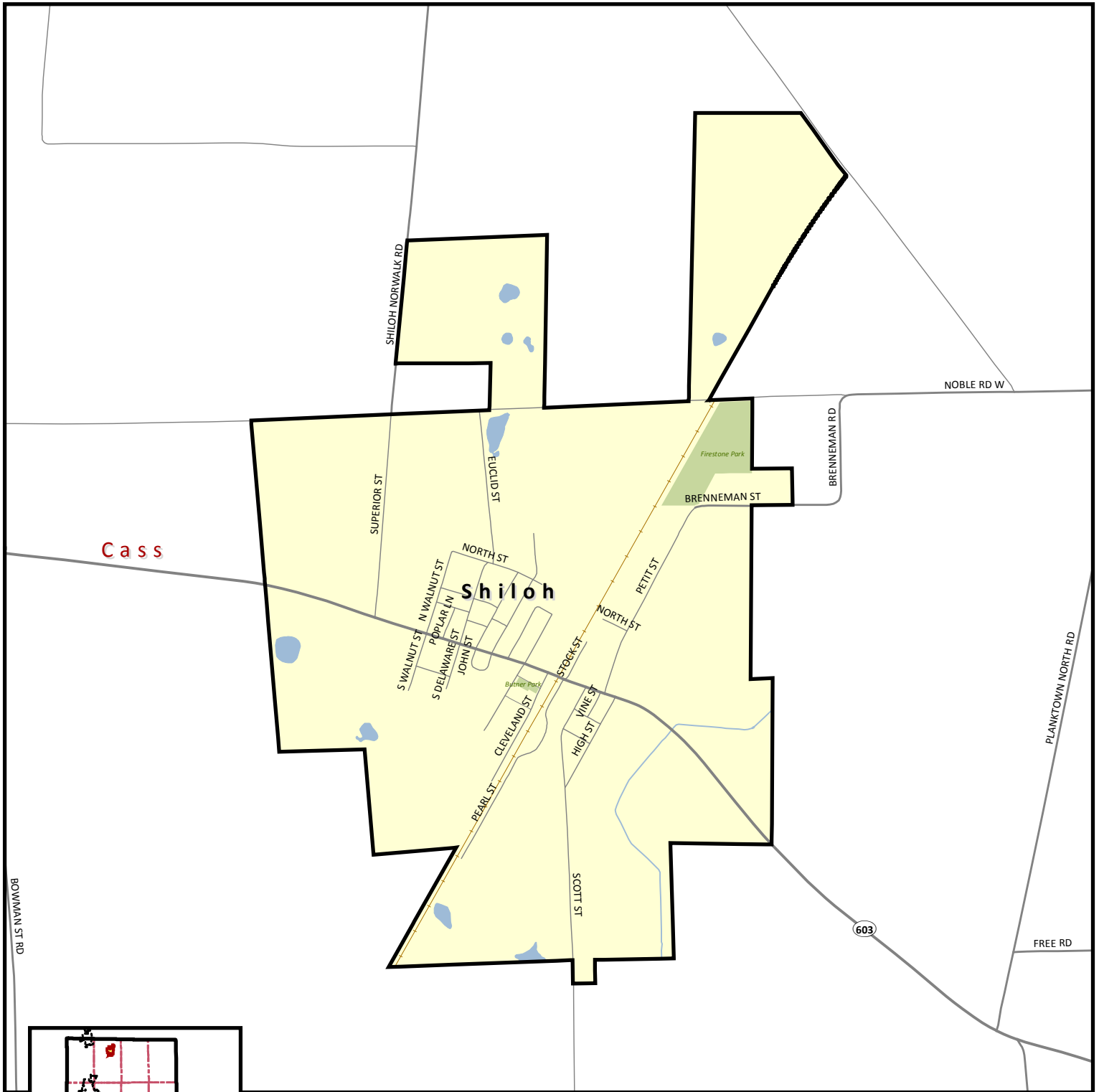

Legend

- Richland County Boundary
- Municipal Corporations
- Townships
- Rail
- Rivers
- Water
- Parks

Shelby

Richland County Regional Planning Commission
 35 North Park Street, Suite 230,
 Mansfield, OH 4490
 phone: 419-774-568, fax: 419-774-5685

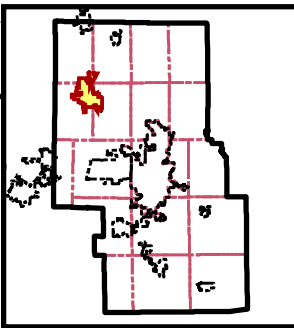
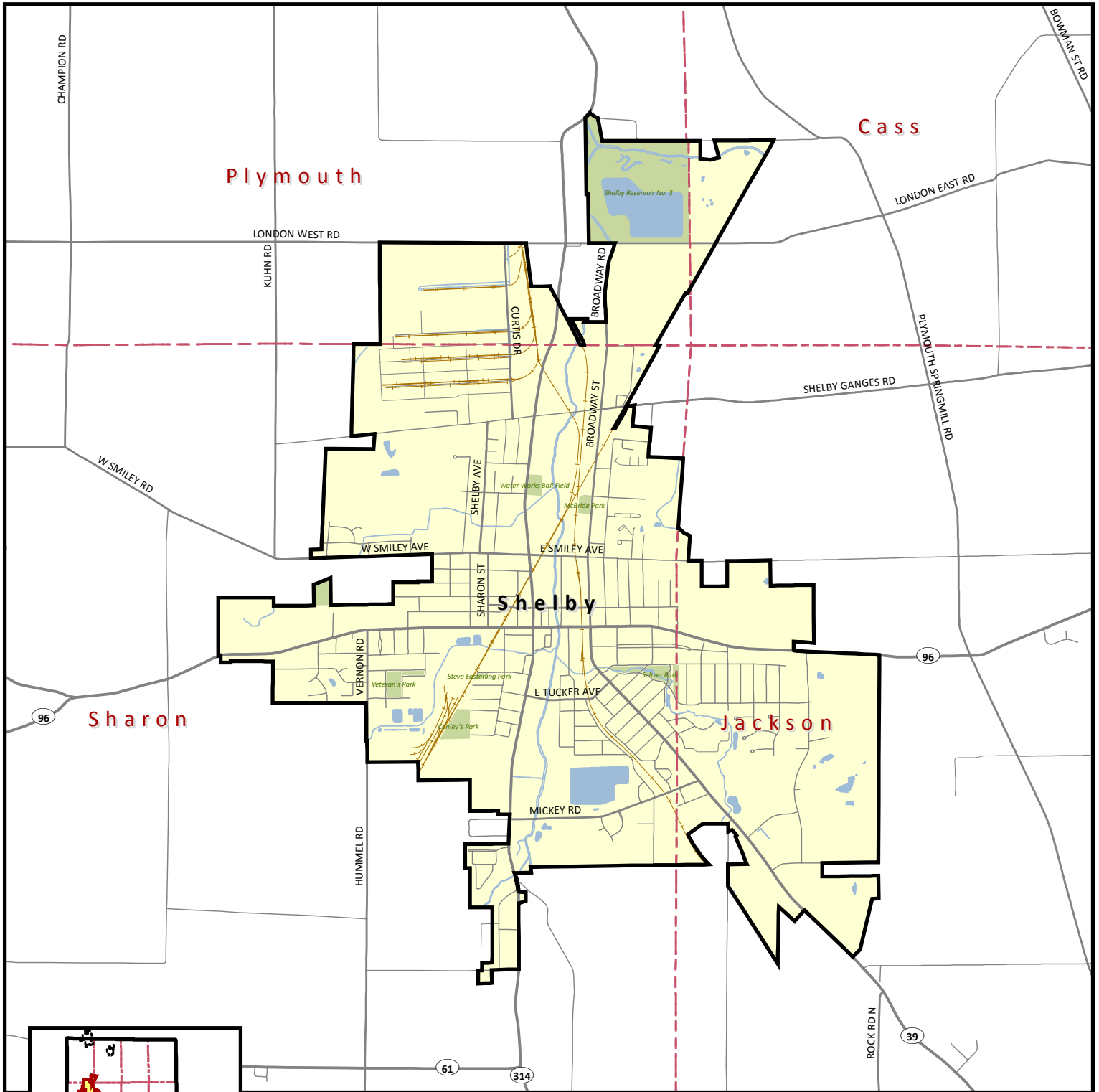

Legend

- Richland County Boundary
- Municipal Corporations
- Townships
- Rail
- Rivers
- Water
- Parks

Plymouth

Richland County Regional Planning Commission
 35 North Park Street, Suite 230,
 Mansfield, OH 4490
 phone: 419-774-568, fax: 419-774-5685

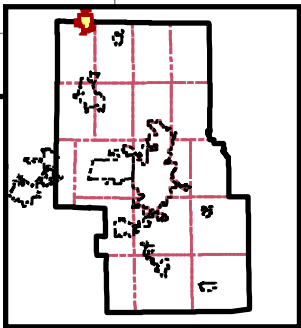
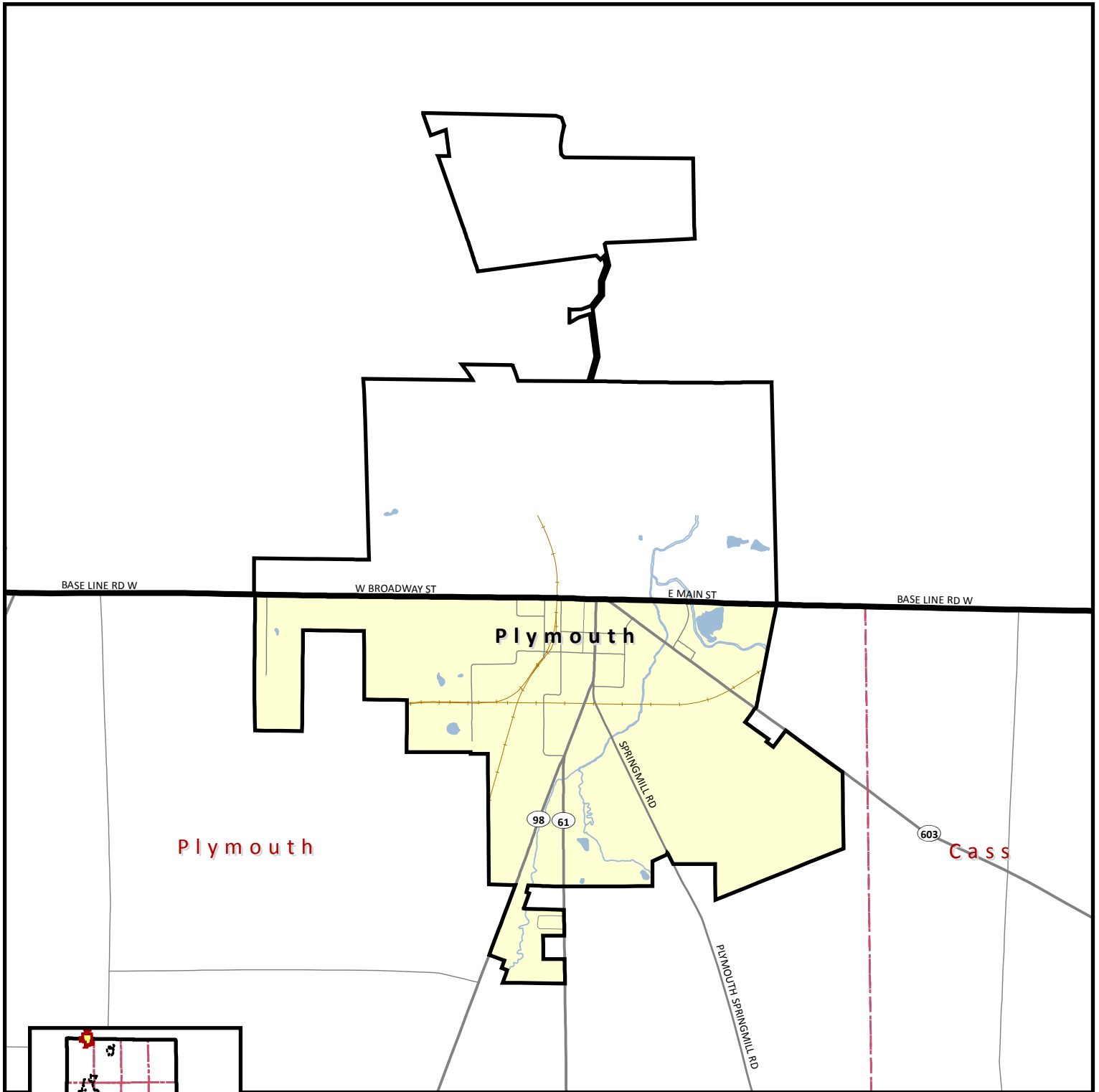

Legend

- Richland County Boundary
- Municipal Corporations
- Townships
- Rail
- Rivers
- Water
- Parks

Butler

Richland County Regional Planning Commission
 35 North Park Street, Suite 230,
 Mansfield, OH 4490
 phone: 419-774-568, fax: 419-774-5685

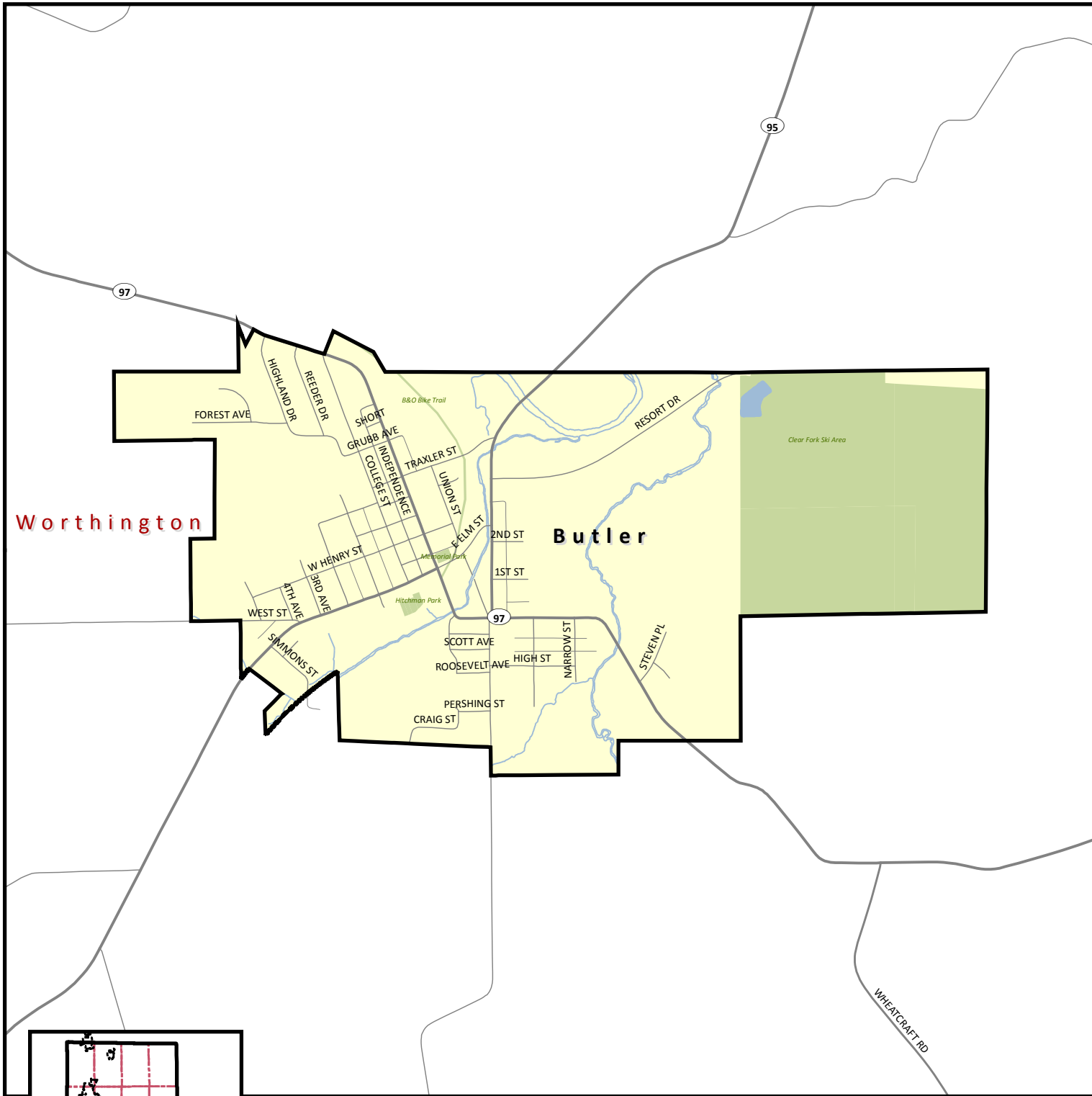

Worthington

Butler

Legend

- Richland County Boundary
- Municipal Corporations
- Townships
- Rail
- Rivers
- Water
- Parks

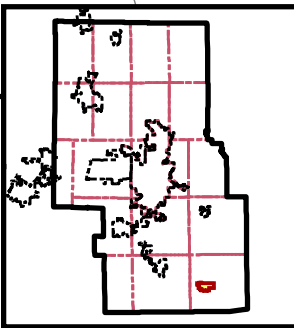

Mansfield

Richland County Regional Planning Commission
 35 North Park Street, Suite 230,
 Mansfield, OH 44901
 phone: 419-774-568, fax: 419-774-5685

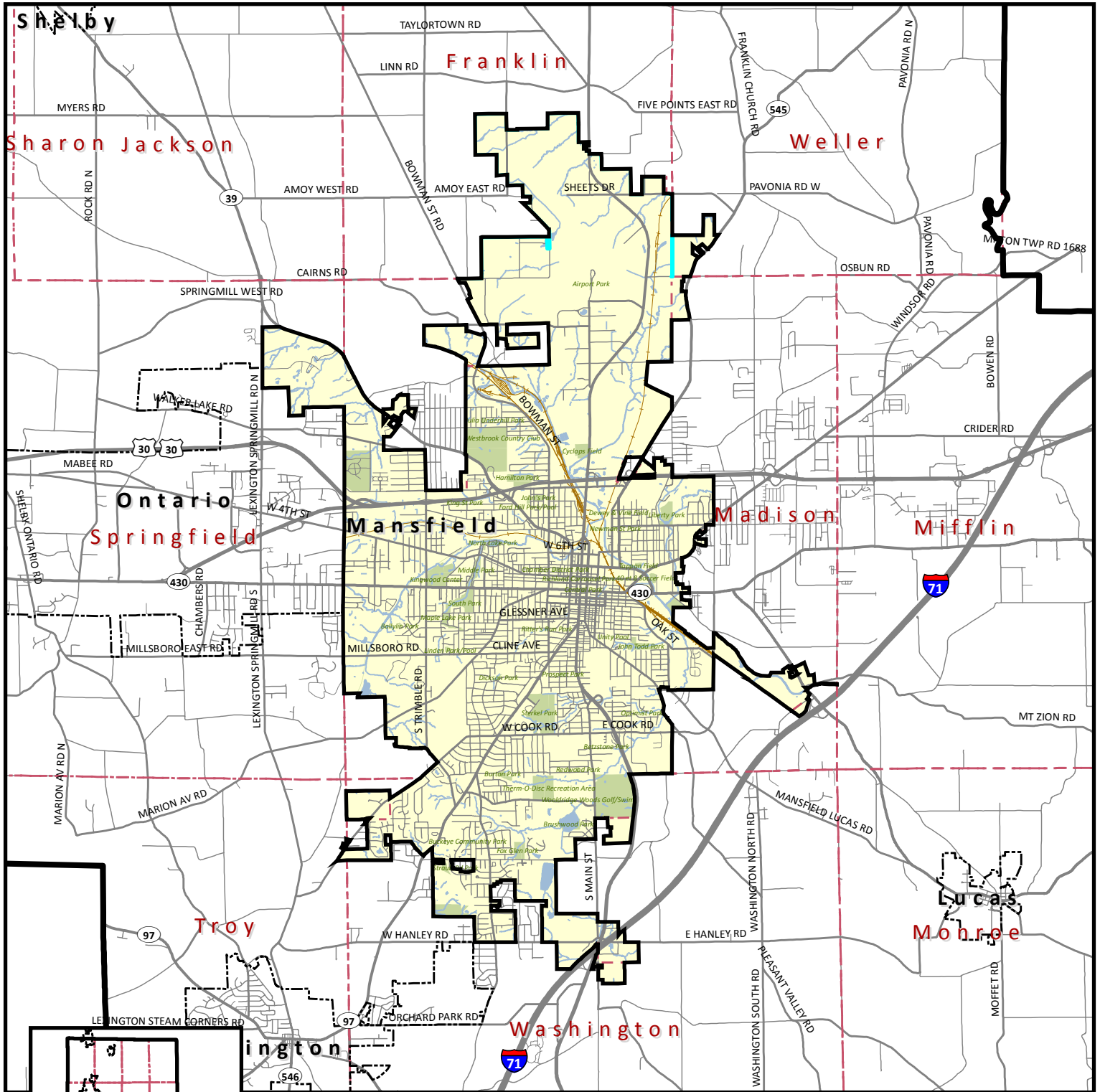

Legend

- Richland County Boundary
- Municipal Corporations
- Townships
- Rail
- Rivers
- Water
- Parks

Lexington

Richland County Regional Planning Commission
 35 North Park Street, Suite 230,
 Mansfield, OH 4490
 phone: 419-774-568, fax: 419-774-5685

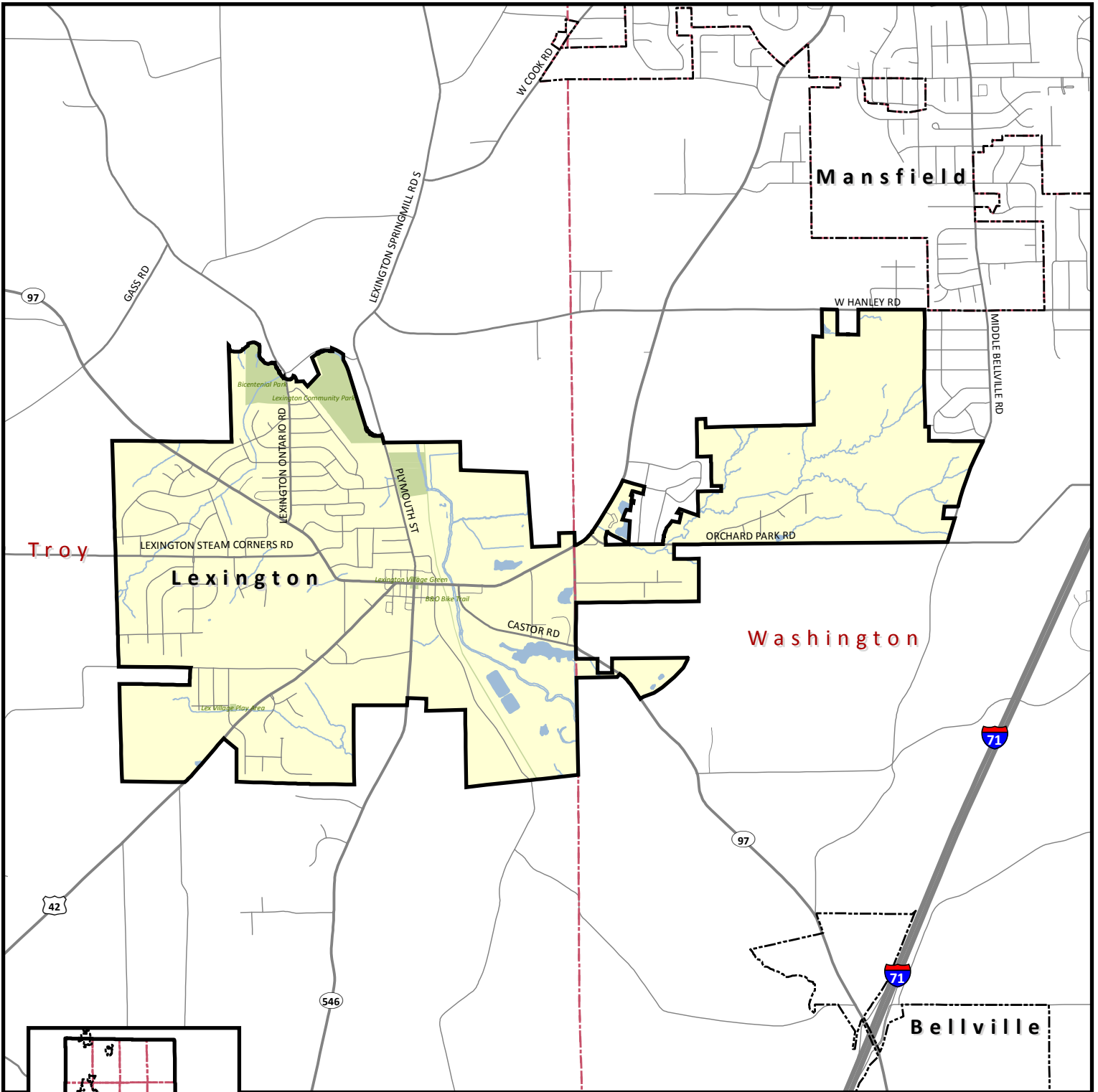

Legend

- Richland County Boundary
- Municipal Corporations
- Townships
- Rail
- Rivers
- Water
- Parks